

Heathland 2
Corfe Castle
Dorset
BH20 5DU

Ref: 003015
Sleeps 8 + cot: One double, one triple, one twin, and a single.



Introduction

- Heathland 2 is a detached former isolation hospital and is one of the last remaining corrugated iron buildings in Dorset
- Located at the end of a narrow single lane and should be approached with care
- There are two cottages at this location, Heathland 2 is clearly signposted
- Accommodation is on one level
- Accommodates 8 guests plus a cot
- There is an open plan kitchen and dining room with a mezzanine room, an open plan lounge with a mezzanine room, a double bedroom, triple bedroom, twin bedroom, single bedroom, utility room, shower room and wet room, and a further separate WC
- The garden is surrounded by open water in the nearby heathland

Floorplan

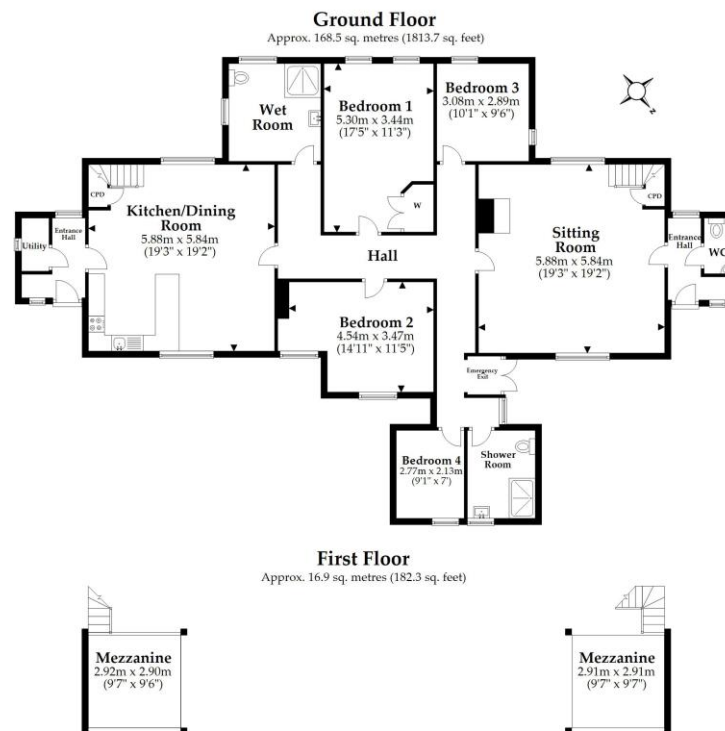

Total area: approx. 185.4 sq. metres (1996.0 sq. feet)
This plan is not to scale and it is for general guidance only. IJT Surveying Ltd Ringwood

Pre-Arrival

- See the main webpage for booking and location details
- Please contact us prior to booking if you have any specific access requirements
- Directions provided with booking

Approach, arrival and parking facilities

- The approach is along a narrow lane
- The drive is on a slope, it can accommodate one car close to the cottage
- Additional parking is available on the grass verge at the entrance to property
- There is a gravel path to the front door which is uneven
- There are two paving stones in front of the entrance and a step at a height of 16cm
- The front door is the main point of entry and opens into the entrance hall. The key is in the “key safe” on the wall by the front door at a height of 175cm
- Front door opening width is 168cm, height is 2 meters, door lock is at a height of 113cm. This is the only entry and exit point.



Getting around the cottage

- Once inside the cottage is one level, with the exception of the mezzanine rooms which are accessed via a narrow staircases
- The front door opens into the entrance hall where there is a separate WC. From the hall the door opens into the sitting room, with a mezzanine room above. The doorway from the lounge leads into the main hall where there are doors into all the bedrooms, bathrooms, the fire exit and the door into the kitchen dining room. From the kitchen

dining room there is a door opening into the back hall where there is the utility room and back door.

- There are three exit points. The front door is the main entry/exit point. There is a fire exit off the main hallway. From the kitchen dining room there is a small hall which leads to the back door.

Entrance hall

- The front door opens into the porch, the width is 70cm and height is 198cm
- Wooden and mat flooring
- Central ceiling light
- Radiator on internal wall
- Two coat racks at heights of 155cm and 184cm
- Two windows on the front and rear walls

WC

- The doorway is 67cm wide and 188cm high
- High level window
- Central ceiling light
- Radiator on internal wall
- Wooden floorboards throughout
- The toilet height is 41cm, the corner sink height is 88cm
- Pillar style taps



Sitting Room

- The doorway has a width of 84cm and height of 212cm
- Straight ahead is the doorway into the main hall, it has a width of 89cm, height of 212cm
- There are stairs on the right leading to the mezzanine. There are 12 steps at a height of 19-20cm, and a width of 57-59cm. The steps are lit by one strip panel containing 2 spotlights. There is a turn on the seventh step and a handrail on the right-side ascending
- Two double spotlight panels, 2 single spotlights 2 wall lights, 2 floor lights and a task lamp with four spotlights
- Wooden flooring throughout
- Wood burner with a fireplace with a heath height of 9cm, mantel place height of 123cm
- There are two radiators on the external walls
- Two sofas with seat heights of 46cm, three chairs with a seat height of between 36-46cm
- Three coffee tables at heights between 47-65cm



Mezzanine

- A banister surrounds the mezzanine at a height of 91cm
- Wall light, floor lamp and 2 table lamps
- There is a TV and chest of drawers
- Table at a height of 76cm, knee clearance of 67cm, and 4 chairs with seat heights of 40cm

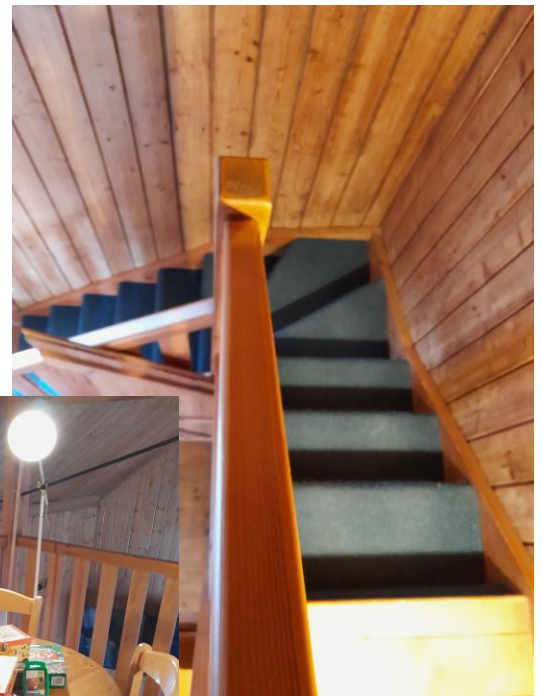

Main hall

- Hall width of between 120-135cm
- Window overlooking driveway
- Five ceiling lights
- As you enter the hall from the sitting room there are three on the right, four doors on the left
- The first door on the right (into floorplan bedroom 3) has a width 66cm and height of 193cm
- The second door on the right (into floorplan bedroom 1) has a width 76cm and height of 201cm
- The third door on the right to the wet room at a width 72cm and height of 194cm
- The first door on the left into the fire exit has a width of 86cm and height of 198cm
- The second door into the shower room has a width 70cm and height of 196cm
- The third door on the left (into floorplan bedroom 4) has a width 70cm and height of 196cm
- The fourth door on the left (into floorplan bedroom 2) has a width 75cm and height of 202cm
- Straight ahead is the door to the kitchen at a width of 86cm and a height of 210cm
- Radiator on internal wall
- Floorboards throughout

Twin bedroom (bedroom number 3 on floorplan)

- Two single beds at a width of 3'92cm x 6'4"/195cm in length x 24"/62cm
- Clearance under beds of 41cm
- Chair seat height 46cm
- Central ceiling light and two bedside lamps
- Two windows, one at a high level of 152cm
- Wooden floorboards and a rug
- Chest of drawers
- Sloping ceiling across entire room, at lowest point 212cm high



Single bedroom (bedroom number 4 on floorplan)

- One single bed at a width of 3'92cm x 6'4''/195cm in length x 24''/62cm
- Clearance under bed of 24cm
- Central ceiling light and bedside light
- Wooden floorboards and a rug
- Chest of drawers
- Window with view of the front of property and surrounding fields
- Radiator on adjoining wall to shower room



Shower room

- Vinyl flooring
- Radiator on adjoining wall to single bedroom
- Window with view of the driveway and surrounding fields
- The toilet height is 40cm, the sink height is 81cm
- Walk in shower with a tray step height of 6cm, controls at a height of 95cm, gap between panels to enter the shower is 40cm wide
- Chair seat height of 45cm
- Central ceiling light



Triple bedroom (bedroom number 2 on floorplan)

- Three single beds at a width of 3'92cm x 6'4''/195cm in length
- Clearance under beds of 34cm
- Chair seat height 46cm
- Central ceiling light and two bedside lamps
- Two windows with a view of the drive and surrounding fields
- Wooden floorboards
- Chest of drawers, a wardrobe and two bedside cabinets
- Radiator on internal wall and mobile radiator

Double bedroom (bedroom number 1 on floorplan)

- Double bed 6'180cm wide x 6'4"/195cm length
- Clearance under the bed is 36cm
- Chair seat height 46cm
- Two ceiling lights and two bedside lamps
- Two windows with view of gardens and surrounding fields
- Wooden floorboards
- Chest of drawers, a wardrobe and two bedside tables

Wet room

- Vinyl flooring
- Radiator on interior wall
- Two windows onto garden
- The toilet height is 44cm, the sink height is 83cm
- Walk in shower with controls at a height of 91cm
- Chair seat height 47cm
- Central ceiling light
- Pillar taps



Kitchen and dining room

- As you enter from the main hallway the doorway width is 86cm and height is 210cm
- Straight ahead is the doorway into the back hall, it has a width of 84cm and a height of 210cm
- There are stairs on the right leading to the mezzanine. There are 12 steps at a height of 18cm, and a width of 58cm. The steps are light by one strip panel containing two spotlights. There is a turn on the seventh step and a rail on the left-side ascending
- The kitchen is on the left, with a worktop height throughout of 92cm. Spotlight panel with four spotlights. Wall and floor cabinets. Four breakfast stools with seat heights of 71cm.
- Lever head mixer taps
- Wooden flooring throughout
- The dining area has a table with a height of 76cm and knee clearance of 62cm, there are six chairs with a seat height of 45-46cm
- There are two radiators on the external walls
- Two wall lights, two single spotlights and one double spotlights
- Two chairs with a seat heights of between 46cm
- Fireplace with wood burner with a mantel height of 127cm, and hearth height of 10cm



Mezzanine

- A banister surrounds the mezzanine at a height of 90cm
- TV and chest of drawers
- Single wall light and two task lamps
- Games table at a height of 66cm
- Book table at a height of 76cm
- Two chairs with seat heights of 35-42cm

Back hall

- The kitchen door opens into the back hall, with a width of 85cm and height of 211cm
- Wooden flooring and coir door mat
- Central ceiling light
- Radiator on internal wall
- Two coat racks at a height of 155cm and 176cm
- Doorway on right to the utility room, with a width of 67cm and height of 195cm
- Two windows on front and rear walls
- The back door has a width of 85cm and height of 211cm

Utility room

- The doorway is 67cm wide and 194cm high
- High level window
- Central ceiling light
- Radiator on internal wall
- Wooden floorboards throughout
- Washer/dryer with worktop above at a height of 1 meter
- Boiler mounted on rear wall

Garden

- The garden is accessed from front door with a walk over uneven grass to the rear
- The garden is mostly lawn and is uneven, there is also a paved and gravel section around the seating area
- Metal bench with a seat height of 40cm
- Two circular tables with heights of 69cm, knee clearance of 60cm, depth 105cm with fixed seats at a height of 45cm
- Views of surrounding fields



- Take care of nearby stream and open water in the surrounding heathland

Additional Information

- Dogs are allowed at this cottage
- In the event of a fire, it is the responsibility of the guest to evacuate themselves. Vibrating fire/smoke detectors are available at the time of booking. Please contact us if you have any specific requirements in this respect.

Facilities at all cottages

The National Trust aims to expand the list of accessible /equipment/items available at each cottage and these may include

- Cordless kettle
- Chair with armrests
- Reading light
- Large handle vegetable peeler
- Easy tin opener
- Non-slip mat for bath/shower
- Information in alternative formats (on request)

Please note that we cannot guarantee that all items will be available at the time of your visit. Please enquire at the time of booking regarding any specific requests.

Specialist equipment

Specialist equipment such as wheelchairs, may be available for loan or purchase from the local Red Cross loan centre. Please check the link below and contact us if you require further information.

[Hire or borrow a wheelchair | British Red Cross](#)

Plan to improve access

- We are currently in the process of writing accessibility guides for all our holiday cottages with the aim to improve access over time for all our guests. All feedback is very helpful and we welcome any comments or ideas from you about access at this cottage. Please do this in the most convenient way for you, see contact details below or information on website. Thank you for assisting us with our improvements.



About the Accessibility Guide

- This Accessibility Guide is intended to provide key information about the accommodation that may be particularly relevant to guests with disabilities. Please contact us prior to booking if you would like information that is more specific to your needs. We will be happy to help.

Email: cottages@nationaltrust.org.uk

Phone: 0344 8002070

Access for all

- The National Trust Access for All office works to improve access at our accommodation and properties. The office welcomes comments and ideas on improving access.

Phone: 01793 818531

Email: accessforall@nationaltrust.org.uk

July 2023