

Ground Floor

Approx. 168.5 sq. metres (1813.7 sq. feet)



First Floor

Approx. 16.9 sq. metres (182.3 sq. feet)

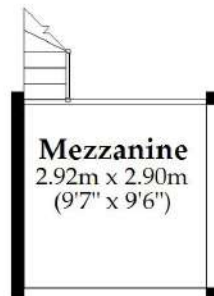

Total area: approx. 185.4 sq. metres (1996.0 sq. feet)

This plan is not to scale and it is for general guidance only. LJT Surveying Ltd Ringwood