

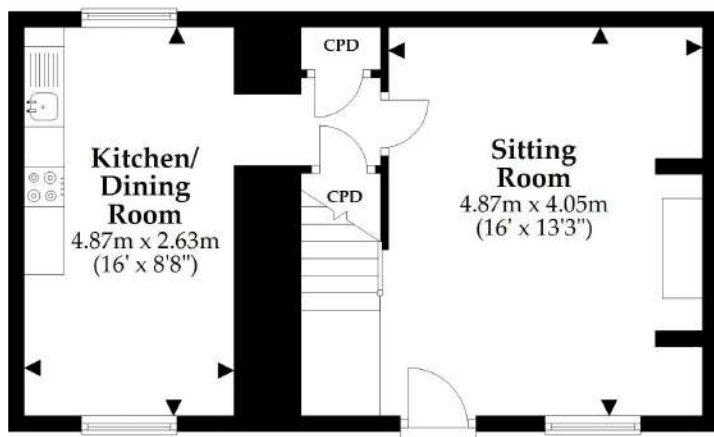

Ground Floor

Approx. 42.1 sq. metres (453.3 sq. feet)



First Floor

Approx. 43.4 sq. metres (467.0 sq. feet)

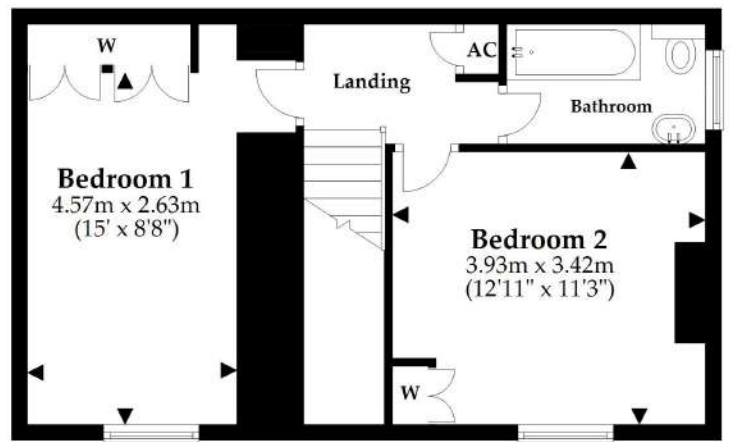

Total area: approx. 85.5 sq. metres (920.3 sq. feet)

This plan is not to scale and it is for general guidance only. LJT Surveying Ltd Ringwood