



National Trust

National Trust Cottages Accessibility Guide

Fishlock's Cottage
Avebury



Property Ref: 003020

Introduction

The property is the last in a lane and located on the outskirts Avebury. It is surrounded by fields and Avebury's standing stones.

Arranged over 2 floors the property sleeps up to 2 people in 1 bedroom with a separate upstairs bathroom.

The property has electric central heating.

The Cottage is arranged as follows:

Ground floor

Stable door leads into the sitting/dining room with windows looking directly on to the henge and stones. Kitchen and separate utility room.

First floor

One double bedroom with 5' antique brass and iron bed. Views from windows to the henge and Marlborough Downs. Bathroom with shower over bath.

Pre-Arrival

- See the main webpage for booking and location details.
- Please contact us prior to booking if you have any specific accessibility requirements.
- Directions provided with booking

Approach

The property is approached off the main road and along a lane where there is limited turning space. It is the last property on the lane surrounded by fields and the standing stones.

Arrival & Parking Facilities

- Parking is on the lane
- Metal front gate, width 960mm
- Grey brick path, width 1060mm. Series of steps up, first step from the lane, height 190mm, tread 1300mm, second step height 190mm, tread 370mm, final step height 170mm
- There is outside lighting by the front door but if arriving after dark it is advisable to have a torch



Getting in (and out) of the cottage

- A press combination key box is to the left of the house on the outbuilding, height 1570mm. It is accessed via a gravel path, width 800mm
- Stable front door, width 800mm, threshold height 70mm, width 150mm opening onto a sunken door mat and the open plan sitting/dining room



Getting around the cottage

Ground floor:

- Ground floor is all on one level with carpet and floor tiles
- There is a back lobby area 1160mm by 1320mm, next to the kitchen, door width 660mm, coat hooks height 1840mm. External door to the front, width 740mm

First floor:

- Straight stairs with quarter turn landing before the last step
- Step height 200mm, tread 240mm, step width 710mm
- Quarter turn landing area, 720mm by 810mm
- Banister on the right
- Main landing width 630mm widening to 790mm after the bathroom



Open Plan Sitting Room/Dining Room

- Direct access from the front door
- Carpet
- Open staircase
- Dual aspect windows, two with views over the front garden and to stones, one with views over the back garden to stones
- 1 x 2 seater settee, seat height 460mm
- 1 x armchair, seat height 410mm
- 2 x wall lights, 1 reading lamp, 1 x double wall light, 2 x floor lamps with foot switch on cable
- Drop leaf round table, height 770mm, clearance underneath 730mm
- 3 x wooden dining chairs, seat height 480mm
- Good circulation



Kitchen

- Door width 740mm, no threshold
- Floor tiles
- Height of worktop is 915mm
- Fitted kitchen with electric single oven and halogen hob, built in fridge, built in dishwasher, recycle bins and microwave
- Belfast sink with mixer tap
- Sunken ceiling spotlights
- Windows over back garden lawn and stones, and front garden area over lane and stones beyond



Utility Room

- Door width 650mm, no threshold, tiled floor
- Electric boiler
- Washer/dryer
- Window over back garden lawn

First Floor:

Double Bedroom

- Door width 740mm, no threshold, doorknob
- Continuation of landing carpet
- Metal bed, width 1500mm, length 2000mm, height 600mm, space under height 360mm
- 2 x bedside table, 2 x bedside lamps with under lampshade on/off switches
- Ceiling pendant light
- Dual aspect windows with views over front and back stones
- Wardrobe, height 460mm
- Rugs x 2 either side of bed
- Mirror on wall
- Good circulation, 800mm each side of the bed and 1000mm at the end



Bathroom

- Door width 660mm, no threshold, doorknob
- Linoleum floor
- Toilet, sink and bath with electric shower
- Toilet height is 420mm with lever handle
- Bath height 560mm with mixer taps and shower head, grab handles
- Shower over bath with fixed shower screen
- Sink height 804mm with washer twist taps
- Ceiling light
- Circulation around the bath 880mm
- Obscure window to the front

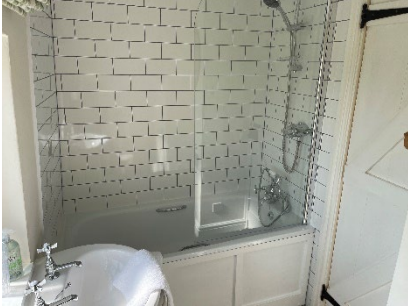

Garden

- Access to the garden is via the front door comprising of front and side garden
- Access to grassed side garden, width 870mm, small step down 50mm, or via wooden gate from the lane, width 1210mm
- Enclosed garden with stock fencing
- Wooden garden companion chairs to the front of the property
- Rattan garden chairs x 2 inside garden with cushions in storage box



Additional Information

- Assistance dogs are welcome at all our cottages
- In the event of a fire, it is the responsibility of the guests to evacuate themselves. Vibrating fire/smoke detectors are available if requested at time of booking. Please contact us if you have any other specific access requirements in this respect.



Facilities at all cottages

The National Trust aims to expand the list of accessible /equipment/items available at each cottage and these may include

- Cordless kettle
- Hollowfibre bedding
- Chair with armrests
- Good reading light
- Large handle vegetable peeler
- Easy tin opener
- Non-slip place mat
- Information in alternative formats (on request)
- Cot and highchair
- 2 oil filled stand-alone radiators

Please note that we cannot guarantee that all items will be available at the time of your visit. Please enquire at the time of booking regarding any particular requests.

Specialist equipment

Other specialist equipment such as wheelchairs, bath seats, toilet frames etc may be available for loan or purchase from the local Red Cross loan centre. Please check this out before booking the Cottage and contact us if you require further information.

<http://www.redcross.org.uk/standard.asp?id=89425>

Future Plans to improve Accessibility to NT Holiday Cottages

We are currently in the process of writing Accessibility guides for all our holiday cottages and improving access over time for all our guests. All feedback is very helpful in informing us of ways in which we can improve access to all our cottages. We welcome any comments or ideas from you about access at this cottage and thank you for taking the time to do this. Please do this in the most convenient way for you. See contact details below or information on website.

About the Accessibility Guide

This Accessibility guide is intended to provide key information about the cottage that may be particularly relevant to guests with disabilities. It is reviewed annually. Please contact us prior to booking if you would like more detailed information and we will be happy to oblige.

Phone: 0344 800 2070

Email: cottages@nationaltrust.org.uk

Access for All at the National Trust

We continue to work to improve accessibility at all our holiday cottages. We welcome comments and ideas on improving access.

Phone: 0344 800 2070

Email: cottages@nationaltrust.org.uk

Floor Plans

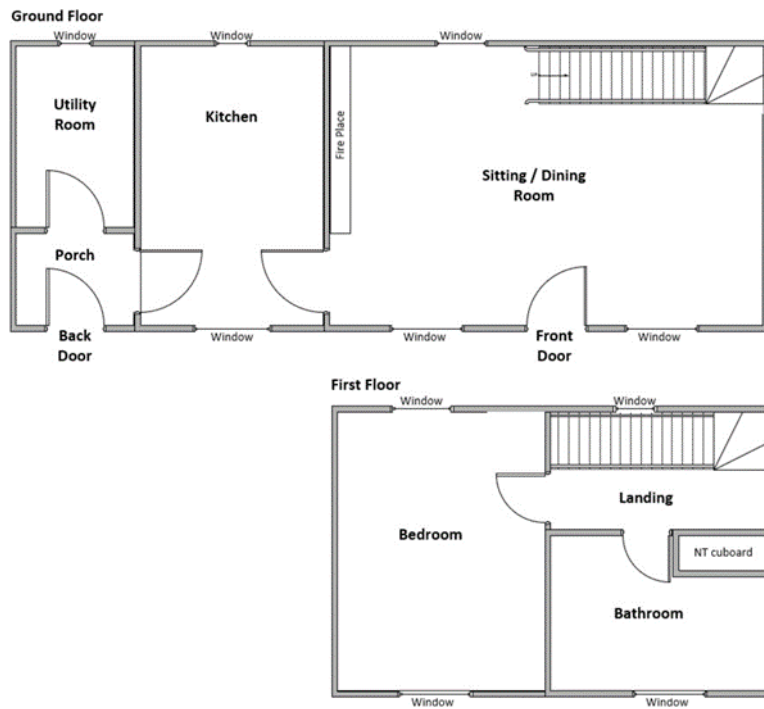

Date 9 October 2023