

Ground Floor

Approx. 42.0 sq. metres (452.5 sq. feet)

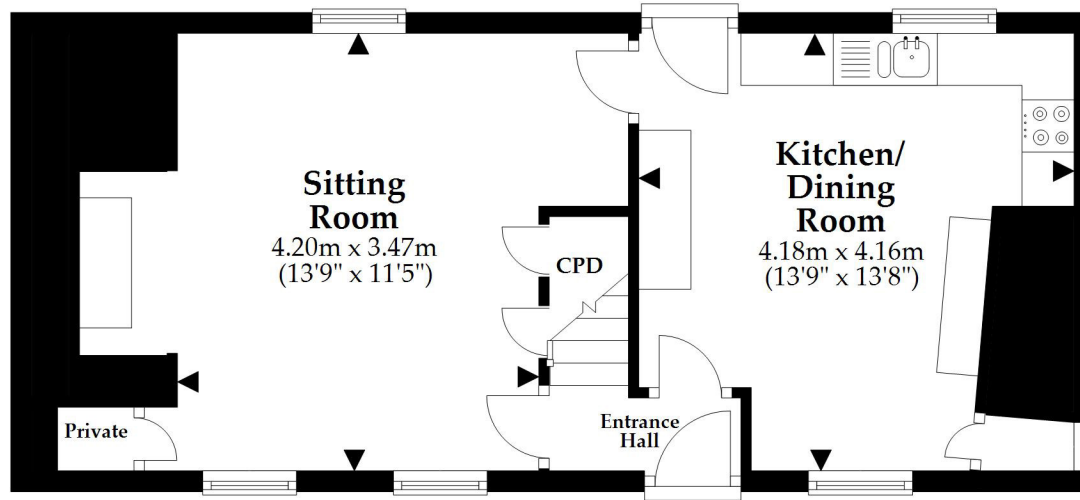
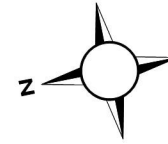

First Floor

Approx. 42.1 sq. metres (452.9 sq. feet)

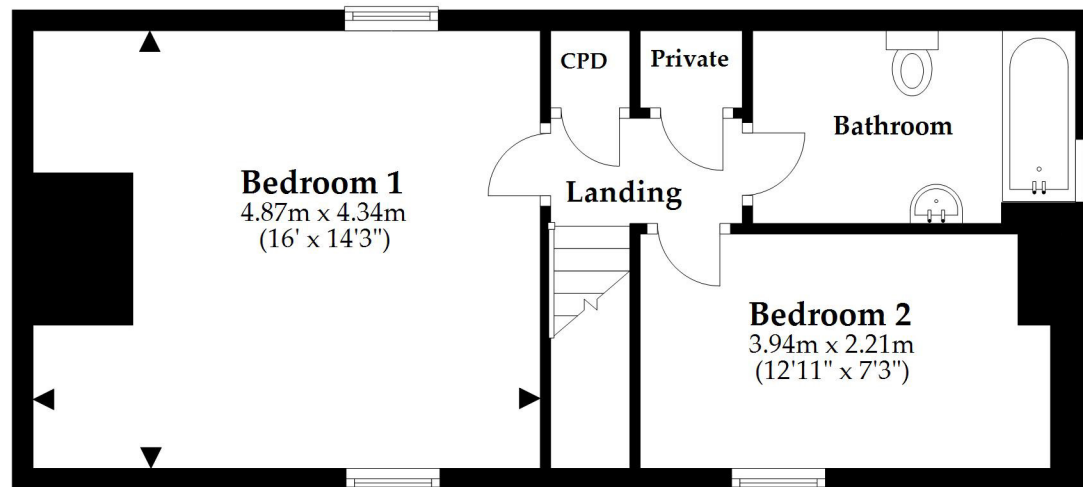

Total area: approx. 84.1 sq. metres (905.5 sq. feet)

This plan is not to scale and it is for general guidance only. LJT Surveying Ltd Ringwood