

The new visitor experience at Studley

A 21st century design inspired
by the characteristics of an
eighteenth century garden.

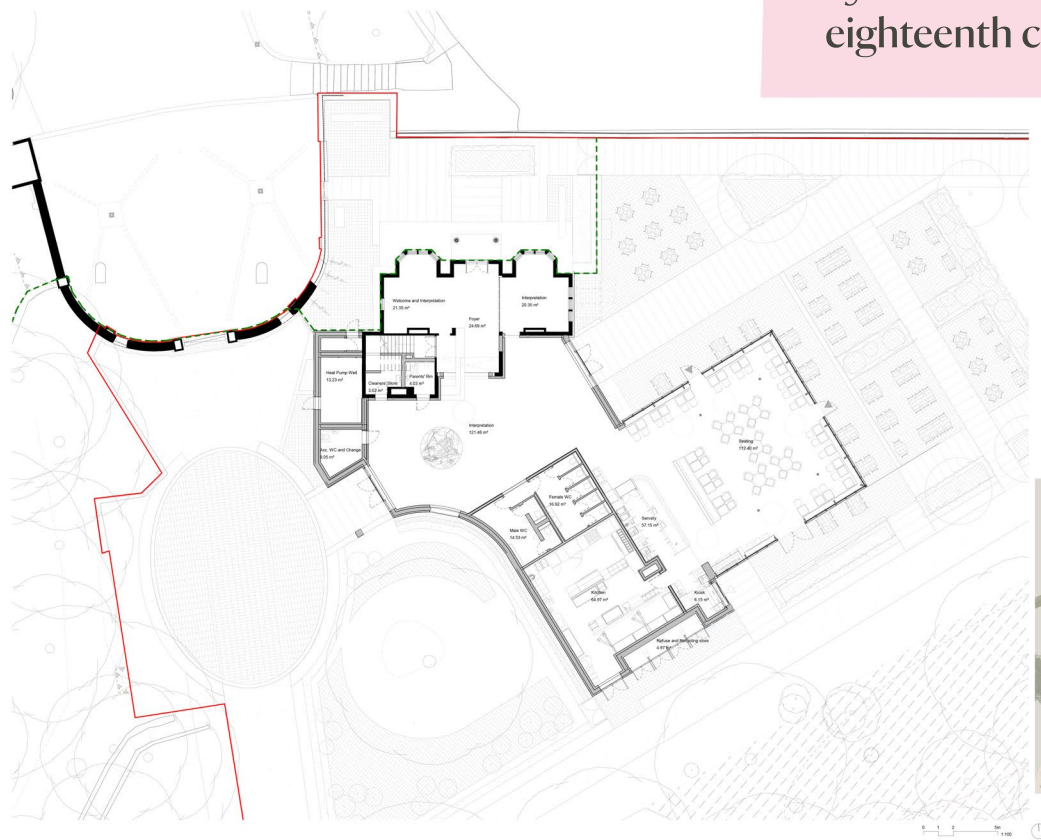

--- Proposed pay for entry area
— Planning application boundary

An illustration of how
the proposed
development might
look.

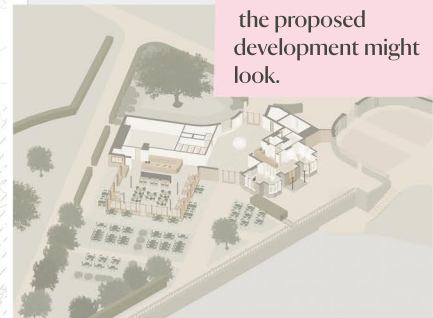

The new design will echo historic experiences,
improve visitor experience, and elevate the
status of this significant place.

- The new design will allow easy flow into the facilities for the 80% of visitors arriving from within the water garden, whilst providing a high-quality welcome to those arriving from the deer park.
- We are submitting a concurrent planning application to provide a refreshment kiosk in the deer park car park that will serve refreshments for those who do not wish to enter the pay for entry area. The café and parking at the main visitor centre will remain free for all to access.
- High quality historical interpretation will engage visitors with the narrative of the site and designed experience of the water garden.
- New toilets, a dog friendly café, and improved access will improve the experience for our visitors.
- A modern kitchen and servery facilities will enable us to efficiently serve food and drinks to visitors who can choose to enjoy them whilst enjoying views of the surrounding landscape, or outside in covered and uncovered spaces.